

HHPSN (Clear Anodize)
HHPBSN (Black Anodize)
HHPSF (For Unequal Size Extrusions: Clear Anodize)

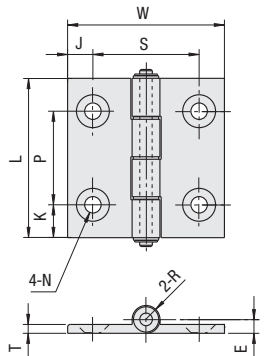

Material: A6063S-T5, Bushing: Polyacetal
 Surface Treatment: Anodize



Example

For a set of screws and nuts for an aluminum extrusion, see **P805**.
 45 Square Extrusion 30 Square Extrusion 30 Square Extrusion 30 Square Extrusion

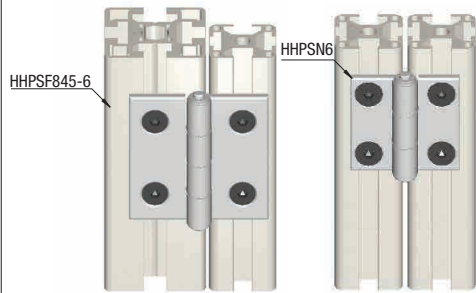

• Hinges for Unequal Size Extrusions
 Connection of Unequal Size Extrusions
 Connection of Equal Size Extrusions
 HHPSF 6-5: Connects a 20 Sq. Extrusion (Slot Width 6mm) to a 30 Sq. Extrusion (Slot Width 8mm).
 HHPSF 8-6: Connects a 30 Sq. Extrusion (Slot Width 8mm) to a 40 Sq. Extrusion (Slot Width 10mm).
 HHPSF 845-5: Connects a 20 Sq. Extrusion (Slot Width 6mm) to a 45 Sq. Extrusion (Slot Width 10mm).
 HHPSF 8-5: Connects a 20 Sq. Extrusion (Slot Width 6mm) to a 40 Sq. Extrusion (Slot Width 10mm).
 HHPSF 845-6: Connects a 30 Sq. Extrusion (Slot Width 8mm) to a 45 Sq. Extrusion (Slot Width 10mm).
 The hinge nuts below are recommended when mating to panels, etc.

Part Number	* Allowable Load	Mass	L	W	K	P	J	S	N	T	E	R	Clear Anodize		Black Anodize		
													Unit Price	Volume Discount Rate	Unit Price	Volume Discount Rate	
HHPSN	5	22	47	36	11	25	7.5	21	5.5	11	3.5	5	5	1 ~ 8 pc (s).	9-50	1 ~ 8 pc (s).	9-50
HHPBSN	6	30	48	48	8.5	30	8	32	6.5	13	5.5	5.5	5.5				
(Black Anodize)	8	48	63	62	13	37	10	42									
	8-45	15	147	70	80	10	43	16.5	4.5	4.5							
	6-5	10	98	33	47	44.75	8.5	30	10.75	26.5	3.5	5.5	5.5				
	8-5	10	98	43	63	54.25	13	37	15.25	31.5	3.5	5.5	5.5				
HHPSF	845-5	10	98	43	63	55.5	13	37	14	34	3.5	5.5	5.5				
(For Unequal Size Extrusions)	8-6	15	147	48	63	62	13	37	12.5	37	3.5	5.5	5.5				
	845-6	15	147	48	63	62	13	37	11.5	39	3.5	5.5	5.5				

*The allowable load is the value when 2 pieces are used.

Aluminum Hinges for Extra Low Head Cap Screws

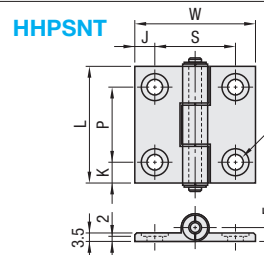

Material: A6063
 Bushing: Polyacetal
 Surface Treatment: Clear Anodize



Example

Standard cap screws can be used for installation.
 The hinge nuts below are recommended when mating to panels, etc.

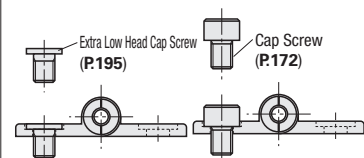

Part Number	* Allowable Load	Mass	L	W	K	P	J	S	d	D	E	Unit Price	Volume Discount Rate
HHPSNT	5	22	47	36	11	25	7.5	21	5.5	10	5		
	6	34	48	48	8.5	30	8	32	6.5	11	5.5		
	8	49	63	62	13	37	10	42					

*The allowable load is the value when 2 pieces are used.

Hinge Nuts

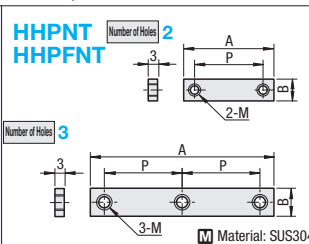

Material: SUS304

Part Number	* Allowable Load	Mass	L	W	K	P	J	S	d	D	E	Unit Price	Volume Discount Rate
HHPNT	5	22	47	36	11	25	7.5	21	5.5	10	5		
	6	34	48	48	8.5	30	8	32	6.5	11	5.5		
	8	49	63	62	13	37	10	42					

Applicable Hinge Nuts for Panel Mounting

Hinges		No.	Applicable Hinge Nut
HHPSN	HHPBSN	5	HHPNT5-2
HHPSJ	SHHPS	6	HHPNT6-2
HHPSDT	HHPSNA	8	HHPNT8-2
HHPSNH	HHPMGS	8	HHPNT845-2
SHPSNA	SHHPSZ	8-45	
HHPNL	HHPNR	8-45	
HHPSSD		8-6	HHPNT8-2
		845-6	
HHPSF		5	HHPNT5-3
		6	HHPNT6-3
SHHPS		8	HHPNT8-3
		845	HHPNT845-3
		5	HHPNT5-2
		6	HHPNT6-2
HHPFLN	HHPFRN	8	HHPNT8-2
HHPFDLN		8-45	
HHPFDNR		8-45	

Not applicable to HHPSJ6, SHPSNA6 and SHHPSZ6.

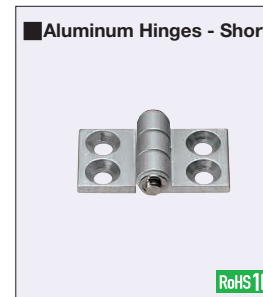

Short Type
HHPSNC (Clear Anodize)
HHPBSNC (Black Anodize)

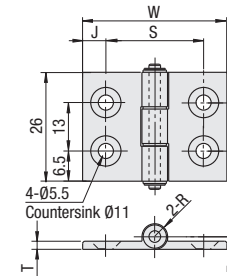

Material: A6063S-T5, Bushing: Polyacetal
 Surface Treatment: Anodize

Part Number	* Allowable Load	Mass	W	J	S	T	E	R	Clear Anodize		Black Anodize	
									Unit Price	Volume Discount Rate	Unit Price	Volume Discount Rate
HHPSNC	5	19	36	7.5	21	3.5	5	5	1 ~ 8 pc (s).	9-100	1 ~ 8 pc (s).	9-100
HHPBSNC	6	24	48	8	32							
(Black Anodize)	8	27	62	10	42							
	8-45	15	147	36	80	16.5	4.5	4.5				

*The allowable load is the value when 2 pieces are used.



Long Type
HHPSNL (Clear Anodize)
HHPBSNL (Black Anodize)

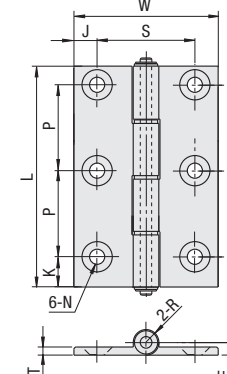

Material: A6063S-T5, Bushing: Polyacetal
 Surface Treatment: Anodize

Part Number	* Allowable Load	Mass	L	W	K	P	J	S	N	T	E	R	Clear Anodize		Black Anodize		
													Unit Price	Volume Discount Rate	Unit Price	Volume Discount Rate	
HHPSNL	5	49	66	36	8	25	7.5	21	5.5	11	3.5	5	5	1 ~ 8 pc (s).	9-100	1 ~ 8 pc (s).	9-100
HHPBSNL	6	69	78	48	9	30	8	32	6.5	13	5.5	5.5	5.5				
(Black Anodize)	8	106	113	62	13.5	43	10	42									
	8-45	23	220	144	80	13.5	43	16.5	4.5	4.5							

*The allowable load is the value when 2 pieces are used.

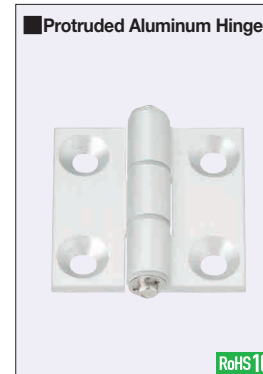

HHPSDT

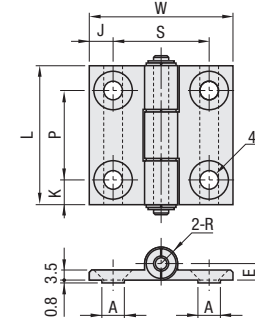

Material: A6063, Bushing: Polyacetal
 Surface Treatment: Clear Anodize



Example

Can be mounted easily since the protrusion prevents lateral misalignment.

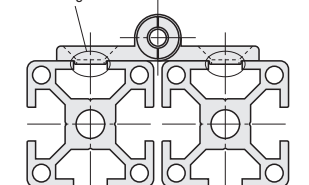

For a set of screws and nuts for an aluminum extrusion, see **P806**.
 The hinge nuts on **P1199** are recommended when mating to panels, etc.

Part Number	* Allowable Load	Mass	L	W	K	P	J	S	N	T	E	A	R	Unit Price		Volume Discount Rate	
														1 ~ 8 pc (s).	9-50	1 ~ 8 pc (s).	9-50
HHPSDT	5	23	47	36	11	25	7.5	21	5.5	11	5	5.5	5				
	6	35	47	48	8.5	30	8	32	6.5	13	5.5	7.5	5.5				
	8	51	63	62	13	37	10	42				9.5	5.5				

*The allowable load is the value when 2 pieces are used.

Ordering Example
 Part Number
HHPSNC5
HHPBSNL8-45
HHPSDT6