

Shaft Collar Wedge

2-Hole / 2-Tapped (Coarse) / 3-Hole / 3-Tapped (Coarse)

■ Features: Less tightening force is required for clamping compared to the conventional clamp types. No constraints on tightening sequence.

■ 2-Hole Type
■ 2-Tapped (Coarse) Type



Type	Shaft Collar	Wedge	Accessory
2-Hole	Material: S45C, Surface Treatment: Black Oxide Coating	Material: SUS304	Hex Socket Head Cap Screw 1 pc.
2-Tapped	Material: S45C Equivalent, Surface Treatment: Electroless Nickel Plating	Material: SUS304	Hex Socket Head Cap Screw 1 pc.
	Material: SUS304 Equivalent	Material: SUS304 Equivalent	Hex Socket Head Cap Screw 1 pc.

⚠ Maximum thrust loads obtained by tightening test are shown on P284.

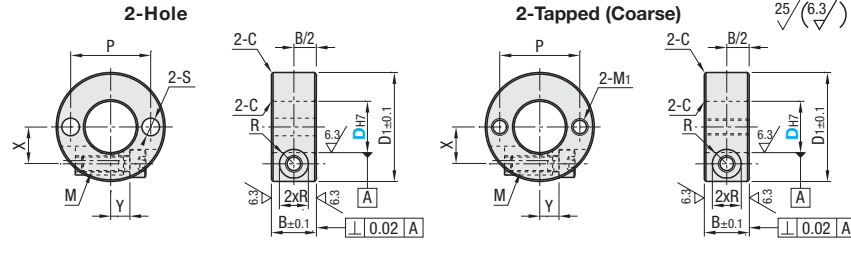

Part Number Type	D	D1	B	P	X	Y	S	M	M1	R	Unit Price		
											SCWM	PSCWM	SSCWM
(2-Hole) SCWM PSCWM SSCWM	10	25	10	18	8.5	3.5	4.5	4	4	4			
	12	28		20	9.5	5							
	15	30		23	11	4.5							
(2-Tapped) SCWW PSCWW SSCWW	16	34	12	25	11.5	6	5.5	5	5	4.5			
	20	38		29	13.5	7							
	25	44		34	16	9							
	30	48	15	39	18.5	8							
	35	56		46	22	9.5	6.6	5	-	-	-	-	
	40	68		54	24.5	18	9	5	-	-	-	-	
50	78	64	29.5	19	-	-	-	-	-	-			

⚠ C (O.D./I.D. Chamfers) will be 1.0 for D30 or more.

■ 3-Hole Type
■ 3-Tapped (Coarse) Type



Type	Shaft Collar	Wedge	Accessory
3-Hole	Material: S45C, Surface Treatment: Black Oxide Coating	Material: SUS304	Hex Socket Head Cap Screw 1 pc.
3-Tapped	Material: S45C Equivalent, Surface Treatment: Electroless Nickel Plating	Material: SUS304	Hex Socket Head Cap Screw 1 pc.
	Material: SUS304 Equivalent	Material: SUS304 Equivalent	Hex Socket Head Cap Screw 1 pc.

⚠ Maximum thrust loads obtained by tightening test are shown on P284.

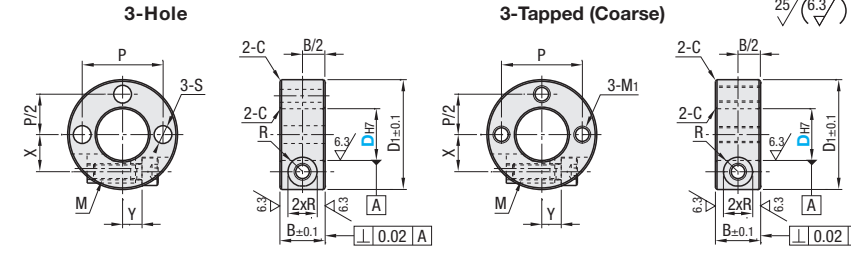

Part Number Type	D	D1	B	P	X	Y	S	M	M1	R	Unit Price		
											SCWT	PSCWT	SSCWT
(3-Hole) SCWT PSCWT SSCWT	10	25	10	18	8.5	3.5	4.5	4	4	4			
	12	28		20	9.5	5							
	15	30		23	11	4.5							
(3-Tapped) SCWR PSCWR SSCWR	16	34	12	25	11.5	6	5.5	5	5	4.5			
	20	38		29	13.5	7							
	25	44		34	16	9							
	30	48	15	39	18.5	8							
	35	56		46	22	9.5	6.6	5	6	-	-		
	40	68		54	24.5	18	9	5	8	-	-		
50	78	64	29.5	19	-	-	-	-	-				

⚠ C (O.D./I.D. Chamfers) will be 1.0 for D30 or more.

Ordering Example
Part Number: SCWM16, PSCWR35

EX Example

⚠ When using the Wedge Type as shown in the diagram on the right, the collar can be fully tightened to the plate first with the screws ① and then the shaft can be clamped using the screw ②.

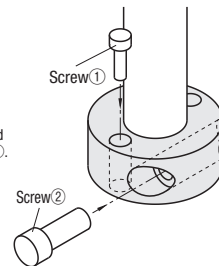

Shaft Collar Compact with Clamp Lever

Wedge - D Cut / Side Mount Hole

■ Features: Less tightening force is required for clamping compared to the conventional clamp types. Smaller by up to 22% in width (B dim.) and 25% in O.D. (D1 dim.) than the Standard Type with Clamp Lever (P.287).

■ D Cut



Type	Shaft Collar	Clamp Lever	Lever Threads	Wedge
Standard	Material: S45C, Surface Treatment: Black Oxide Coating	Material: Zinc Diecast, Surface Treatment: Baked Paint	Material: SUM24L, Surface Treatment: Black Chromate	Material: C3604
Miniature	Material: S45C Equivalent, Surface Treatment: Electroless Nickel Plating	Material: Zinc Diecast, Surface Treatment: Baked Paint	Material: SUS303, Surface Treatment: -	Material: C3604

⚠ Clamp Lever Details P.2-1139 Miniature Clamp Lever Details P.2-1141

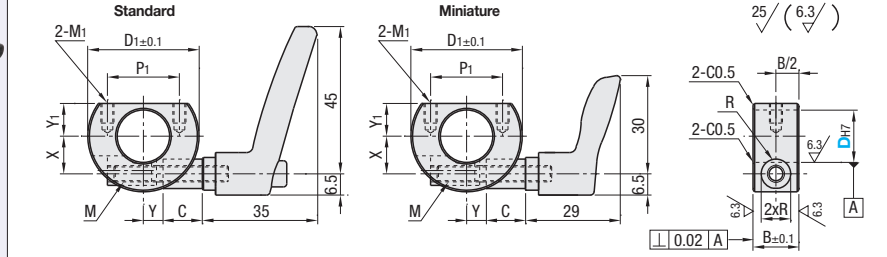

■ Side Mount Hole Type



Type	Shaft Collar	Clamp Lever	Lever Threads	Wedge
Standard	Material: S45C, Surface Treatment: Black Oxide Coating	Material: Zinc Diecast, Surface Treatment: Baked Paint	Material: SUM24L, Surface Treatment: Black Chromate	Material: C3604
Miniature	Material: S45C Equivalent, Surface Treatment: Electroless Nickel Plating	Material: Zinc Diecast, Surface Treatment: Baked Paint	Material: SUS303, Surface Treatment: -	Material: C3604

⚠ Clamp Lever Details P.2-1139 Miniature Clamp Lever Details P.2-1141

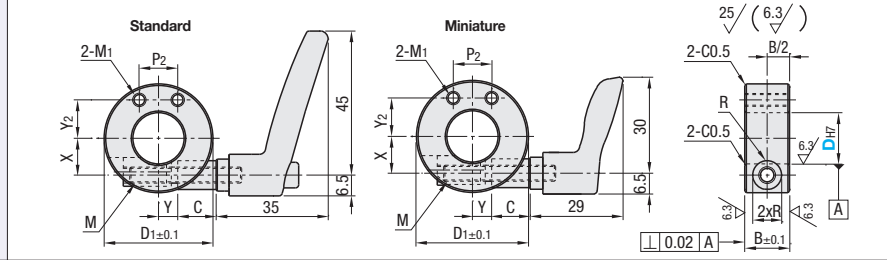

D	B	D1	M	M1	P1	P2	Y1	Y2	R	X	Y	C
10	14	28	4	M4	18	10	7	9	4	8.5	4.5	11
12		28			18		8	9.5		9.5	4	11
15		32			20		9.5	11		11	5.5	11
16		34	5	M5	22	12	10	12	4.5	11.5	6	12
20		40			25	14	13	14		13.5	8	12
25		45	29	18	14.5	16.5	16	9	12			
30	52	30	22	19	19	18.5	11.5	12				

Part Number Type	D	Lever Color	D Cut			Side Mount Hole			Lever
			SCWD	PSCWD	SSCWD	SCWJ	PSCWJ	SSCWJ	
Standard Lever	10	M (Orange)							CLDF□(CLFS□)4-7-M/B/S
	12								
	15								
	16								
Miniature Lever	20	S (Silver Grey)						CLDF□(CLFS□)5-7-M/B/S	
	25								
	30								

⚠ Levers in () are applicable to SSCWD□ and SSCWJ□ (stainless steel products). ⚠ C (O.D./I.D. chamfers) will be 1.0 for D30.

Ordering Example
Part Number: SCWD12, PSCWJ16, SSCWDM16
Lever Color: B, M, S

⚠ Thickness / O.D. Comparison Table

D	Dimension Differences		Wedge		Standard (P249)	
	B (Thickness)	D1 (O.D.)	B (Thickness)	D1 (O.D.)	B (Thickness)	D1 (O.D.)
10	-4	-7	14	28	18	35
12	-4	-12	14	28	18	40
15	-4	-12	14	32	18	44
16	-4	-12	14	34	18	44
20	-4	-8	14	40	18	48
25	-4	-15	14	45	18	60
30	-4	-18	14	52	18	70